

SEC. 12, TWP 13N, RGE 15E  
Muskogee  
WELL NO 1  
Garrett  
FARM NAME

Form 1002A

(Mail to Corporation Commission Oklahoma City Oklahoma)  
**OKLAHOMA CORPORATION COMMISSION**  
OIL AND GAS CONSERVATION DEPARTMENT

**WELL RECORD**

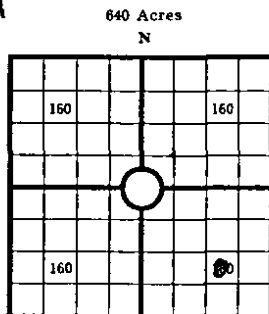

COUNTY Muskogee SEC 12 TWP 13 N RGE 15 E  
COMPANY OPERATING J. M. Graves  
OFFICE ADDRESS 1600 Mid-Cont. Bldg. Tulsa, Okla.  
FARM NAME Garrett WELL NO 1  
DRILLING STARTED 10-2-59 DRILLING FINISHED 10-15-59  
DATE OF FIRST PRODUCTION 10-30 COMPLETED 11-25-59  
WELL LOCATED NW  $\frac{1}{4}$  Se  $\frac{1}{4}$  Se  $\frac{1}{4}$  990 North of South  
Line and 1650 ft East of West Line of Quarter Section  
Elevation (Relative to sea level) DERRICK FLOOR 940 GROUND 936  
CHARACTER OF WELL (Oil gas or dryhole) Oil

**OIL OR GAS SANDS OR ZONES**

Name	From	To	Name	From	To
1 Dutcher	1912	1985	4		
2 Cromwell	2156	2172	5		
3			6		

**Perforating Record If Any**

**Shot Record**

Formation	From	To	No. of Shots	Formation	From	To	Size of Shot
Dutcher	1915	27	24				
	1963	87	50				

**CASING RECORD**

Amount Set							Amount Pulled		Packer Record	
Size	Wt	Thds	Make	Ft	In	Ft	In	Size	Length	Depth Set
8 5/8	28			55						
4 1/2	9			2204						2000

Liner Record Amount Kind Top Bottom

**CEMENTING AND MUDDING**

Size	Amount Set		Sacks Cement	Chemical		Method of Cementing	Amount	Mudding Method	Results (See Note)
	Ft	In		Gal	Make				
8 5/8	55		45						
2204	4 1/2		150						

Note What method was used to protect sands if outer strings were pulled?

NOTE Were bottom hole plugs used? If so state kind depth set and results obtained

**TOOLS USED**

Rotary Tools were used from 0 feet to 2208 Cable tools were used from \_\_\_\_\_ feet to \_\_\_\_\_  
\_\_\_\_\_ feet and from \_\_\_\_\_ feet to \_\_\_\_\_ feet and from \_\_\_\_\_ feet to \_\_\_\_\_  
Type Rig Portable

**INITIAL PRODUCTION TEST**

Describe initial test whether by flow through tubing or casing or by pumping  
130 bbls. of oil in 4 hours thru casing  
Amount of Oil Production 395 bbls Size of choke if any 14/64 Length of test 24 hr. Water  
Production 50 bbls Gravity of oil 42 Type of Pump if pump is used describe \_\_\_\_\_

**FORMATION RECORD**

Give detailed description and thickness of all formations drilled through contents of sand whether dry water oil or gas

Formation	Top	Bottom	Formation	Top	Bottom
Sandy shale	0	500			
Salt sand	500	744			
Shale	744	995			
Booch sand	995	1016			
Limy shale	1016	1522			
Lime	1522	1534			
Shale	1534	1564			
Lime	1564	1598			
Limy shale	1598	1659			
Lime	1659	1677			
Shale	1677	1742			
Lime	1742	1786			
Shale	1786	1912			
Sand-brn stn	1912	1926			
Shale	1926	1929			
Sand-white	1929	1954			
Shale	1954	1960			
Sand-brn stn	1960	1984			
Limy shale	1984	2020			
Sand-brn stn	2020	2030			
Sand-white	2030	2076			
Shale	2076	2082			
Lime	2082	2156			
Sand-brn stn	2156	2172			
Shale	2172	2208			
		T.D.			

I the undersigned being first duly sworn upon oath state that this well record is true correct and complete according to the records of this office and to the best of my knowledge and belief

Name and title of representative of company

Subscribed and sworn to before me this 28th day of December 1959

My Commission expires \_\_\_\_\_

My Comm

10, 1963

Notary Public

## Instructions

- A. Please type or print using black ink.  
 B. Form must be signed by former operator and new operator.  
 C. Outline boundaries of lease and spot well being transferred.  
 D. Attach 1002A for well.  
 E. Questions should be directed to Well Records (405) 521-2275.

## OKLAHOMA CORPORATION COMMISSION

Oil & Gas Conservation Division  
 Post Office Box 52000-2000  
 Oklahoma City, OK 73152-2000

Transfer of Operator  
 OAC 165:10-1-15

809020613

Form 1073  
 Rev. 1996

API No. 35-101-03207		OTC Prod. Unit No. 101-30839	
Location 1/4 NW 1/4 SE 1/4 SE 1/4		Sec. 12	Twp. 13N
Rge. 15E			
Ft FSL of Qtr Sec 990		Ft FWL of Qtr Sec 1650	
County Muskogee			
Current Well Name/No. Garrett # 1			
Original Well Name/No. Garrett # 1			
Unit Name (if applicable) Garrett			

2310'							
1650'							
990'							
330'							
2310'							
1650'							
990'							
330'							

Locate Well On Grid Above

Well Class: ☒ Oil ☐ Gas ☐ Dry ☐ Plugged

Producing formation(s) Dutcher	
Oil Transporter/Purchaser Koch Oil Company	OTC No. 01842
Gas Measurer	OTC No.

The effective date of transfer of this well for the purposes of Commission records, is the date the transfer is approved by the Commission.

## CURRENT OPERATOR

Name J.M. Graves Oil Properties		OCC No. 00879
Address 2455 E. 51st St., Suite 101		
City Tulsa	State OK	Zip 74105
Phone No. (918) 749-3606	FAX No. (918) 749-3693	
I verify that I am the legal operator of record with authority to transfer operatorship of this well.		
Signature <i>J.M. Graves</i>		
Name & Title (Typed or Printed) J.M. Graves		
Signed and sworn to before me this 12 day of June, 1998		
Notary Public <i>Ginger Miller</i>		
My commission expires: 4-30-2001		

## NEW OPERATOR

Name J.L. Watkins		OCC No. 18957
Address P.O. Box 325		
City Morris	State OK	Zip 74445
Phone No. (918) 756-6906	FAX No. (918) 756-2616	
Being the new operator, as of the effective date and time of transfer accept the facts presented as being true and correct and accept the operational responsibility for the well on the described property.		
Signature <i>J.L. Watkins</i>		
Name & Title (Typed or Printed) J.L. Watkins		
Signed and sworn to before me this 8 day of July, 1998		
Notary Public <i>Ginger Miller</i>		
My commission expires: 4-30-2001		

I verify under oath that I have exercised due diligence in attempting to locate the current operator of record according to OCC records, who has abandoned the above well/lease and cannot be located to obtain signature. I have attached a copy of the certified recorded assignment of lease.

Signature

Signed and sworn to before me this \_\_\_\_\_ day of \_\_\_\_\_

Notary Public

My commission expires: \_\_\_\_\_

## FOR OCC USE ONLY

Surety Dept. ☒ Approved ☐ Rejected Date SEP 02 1998 Well Records Dept. ☒ Approved ☐ Rejected

OCT 14 1998

WDMS

NOTE: By processing this Form 1073, the Oklahoma Corporation Commission has approved the contents thereof as to form only. Oklahoma Corporation Commission does not warrant that the facts provided by the operator are true. Form is not approved until approved by Well Records.



- A. Please type or print using black ink  
 B. Form must be signed by former operator and new operator  
 C. Outline boundaries of lease and spot well being transferred  
 D. Attach 1002A for well  
 E. Questions should be directed to Well Records (405) 521-2275

Oil & Gas Conservation Division  
 Post Office Box 52000  
 Oklahoma City, OK 73152-2000

**Transfer of Operator**  
 OAC 165:10-1-15

20620 642  
 6280 ft

API No. 35-101-03207	OTC Prod. Unit No. 101-30839
Location 1/4 N W 1/4 S E 1/4 S E 1/4	Sec 1 2
FWL of Qtr Sec 9 9 0	FWL of Qtr Sec 1 6 5 0
Current Well Name/No G A R R E T T 1	Twp. 1 3 N
Original Well Name/No G A R R E T T 1	Rgc. 1 5 E
Unit Name (if applicable)	County M U S K O G E E

2310'  
1650'  
990'  
330'  
2310'  
1650'  
990'  
330'

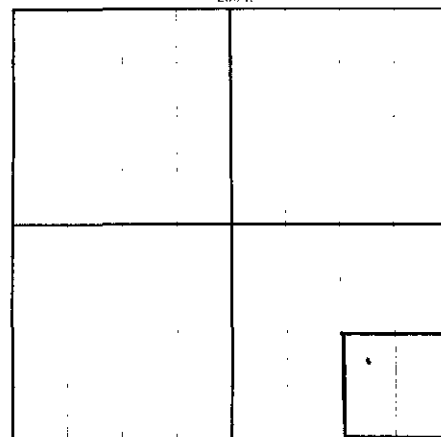

Locate Well On Grid Above

Well Class ☒ Oil ☐ Gas ☐ Dry ☐ Plugged

Producing formation(s)

DUTCHMAN

Oil Transporter/Purchaser

SUN COMPANY R&M

Gas Measurer

OTC No.

1 5 2 3 4

OTC No.

The effective date of transfer of this well for the purposes of Commission records, is the date the transfer is approved by the Commission.

**CURRENT OPERATOR**

Name J.L. WATKINS	OCC No. 1 8 9 5 7
Address P.O. BOX 325	
City MORRIS	State OK
Phone No. 918-756-6906	Zip 7 4 4 4 5
FAX No. 918-756-2616	
I verify that I am the legal operator of record with authority to transfer operatorship of this well.	
Signature 	
Name & Title (Typed or Printed) J.L. WATKINS OWNER	
Signed and sworn to before me this 1 day of May, 2002	
Notary Public 	
My commission expires: 12-27-2004	

**NEW OPERATOR**

Name REVULO EXPLORATION, INC.	OCC No. 1 4 7 6 3
Address 404 W. 8th STREET	
City OKMULGEE	State OK
Phone No. 918-752-0682	Zip 7 4 4 4 7
FAX No. 918-752-0686	
Being the new operator, as of the effective date and time of transfer accept the facts presented as being true and correct and accept the operational responsibility for the well on the described property	
Signature 	
Name & Title (Typed or Printed) BRADLY J. OLIVER PRESIDENT	
Signed and sworn to before me this 1 day of May, 2002	
Notary Public 	
My commission expires: 12-27-2004	

I verify under oath that I have exercised due diligence in attempting to locate the current operator of record according to OCC records, who has abandoned the above well/lease and cannot be located to obtain signature. I have attached a copy of the certified recorded assignment of lease.

Signed and sworn to before me this \_\_\_\_\_ day of \_\_\_\_\_

Signature

Notary Public

My commission expires: \_\_\_\_\_

FOR OCC USE ONLY

Surety Dept. ☒ Approved ☐ Rejected Date \_\_\_\_\_

Well Records Dept. ☒ Approved ☐ Rejected Date \_\_\_\_\_

**NOTE:** By processing this Form 1073, the Oklahoma Corporation Commission has approved the contents thereof as to form only. Oklahoma Corporation Commission does not warrant that the facts provided by the operator are true. **Form is not approved until approved by Well Records.**

JUN 24 2002

JUN 24 2002

WDA

## Instructions

- A Please type or print using black ink  
 B Form must be signed by former operator and new operator  
 C Outline boundaries of lease and spot well being transferred  
 D Attach 1002A for well.  
 E Questions should be directed to Well Records (405) 521-2275.

## OKLAHOMA CORPORATION COMMISSION

Oil & Gas Conservation Division  
 Post Office Box 52000-2000  
 Oklahoma City, OK 73152-2000

Form 1073  
 Rev 1996

Transfer of Operator  
 OAC 165-10-1-15

API No 35-101-03207 OTC Prod Unit No 101-30839  
 Location 1/4 NW 1/4 SE 1/4 SE 1/4 Sec 12 Twp. 13N Rge. 15E  
 Ft FSL of Qtr Sec 990 Ft FWL of Qtr Sec 1650  
 County Muskogee  
 Current Well Name/No. Garrett #1  
 Original Well Name/No. Garrett #1  
 Unit Name (if applicable)

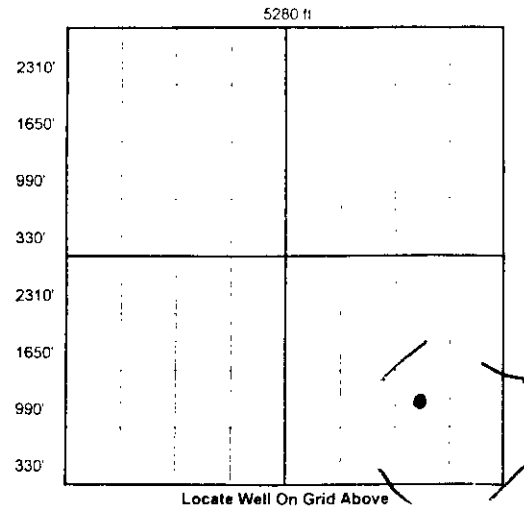

Well Class: ☒ Oil ☐ Gas ☐ Dry ☐ Plugged

## Producing formation(s)

Dutcher

Oil Transporter/Purchaser

Independent Energy Service, Inc

Gas Measurer

OTC No. 17688  
 OTC No.

The effective date of transfer of this well for the purposes of Commission records, is the date the transfer is approved by the Commission.

## CURRENT OPERATOR

Name Revilo Exploration, Inc. OCC No. 14763  
 Address 404 W 8th St  
 City Okmulgee State OK Zip 74447  
 Phone No. 918-752-0682 FAX No. 918-752-0686  
 I verify that I am the legal operator of record with authority to transfer operatorship of this well

Signature

Bradly J Oliver, President

Name &amp; Title (Typed or Printed)

Signed and sworn to before me this 23rd day of September 2002

Notary Public Oklahoma  
My commission expires 09/14/04PHYLIS L. DITTMAR  
Notary Public  
Commission Expires 12/2/2004

I verify under oath that I have exercised due diligence in attempting to locate the current operator of record according to OCC records, who has abandoned the above well/lease and cannot be located to obtain signature. I have attached a copy of the certified recorded assignment of lease.

## NEW OPERATOR

Name Ray Oil Company OCC No. 11803-0  
 Address P O Box 135  
 City Council Hill State OK Zip 74428  
 Phone No. 918-474-3563 FAX No.

Being the new operator, as of the effective date and time of transfer accept the facts presented as being true and correct and accept the operational responsibility for the well on the described property

Signature

Ronald Ray, owner  
Name & Title (Typed or Printed)

Signed and sworn to before me this 2nd day of October 2002

Notary Public  
My commission expires 09/14/04

Signature

Signed and sworn to before me this \_\_\_\_\_ day of \_\_\_\_\_

My commission expires: \_\_\_\_\_

Notary Public

OCT 11 2002

FOR OCC USE ONLY

Surety Dept. ☒ Approved ☐ Rejected Date OCT 10 2002Well Records Dept. ☒ Approved ☐ Rejected Date WDMS

NOTE: By processing this Form 1073, the Oklahoma Corporation Commission has approved the contents thereof as to form only. Oklahoma Corporation Commission does not warrant that the facts provided by the operator are true. Form is not approved until approved by Well Records.